



Disability Policy and Programs PARENT FORUM

2017

WEDNESDAY 21 JUNE 2017

Disability Policy and Programs Parent Forum

Are you a parent or carer a child or young person with a disability then we would like to invite you to the 3rd in a series of Parents Forums hosted by the Department for Education and Child Development.

The forum is an opportunity to:

- Have a say, be listened to and be engaged in conversations
- Be informed about initiatives and new directions
- Share your ideas with other parents and carers about the services and support available for students with a disability.

Wednesday 21 June 2017

Education Development Centre
Rooms G 11A & B (map attached)
4 Milner Street, Hindmarsh SA 5007

9:30 am – 10:00 am Tea & coffee
10:00 am – 2:00 pm Parent Forum

A light lunch will be provided. A map to help with parking and details about public transport connections are attached.

To ensure a place, please book your seat and notify us of any dietary requirements by emailing your RSVP to Julie.cakebread68@schools.sa.edu.au or by phoning the Special Education Resource Unit (SERU) on (08) 8235 2871 by Friday 16 June 2017. A detailed agenda will be forwarded on confirmation of your booking.

Location and access to the Education Development Centre

PARKING CAN BE AT A PREMIUM

Parking

The Education Development Centre car park is located on Orsmund Street and runs off Milner Street. Parking is available for 180 vehicles.

Taxi

A complimentary Adelaide Independent Taxi phone is located just inside the main entrance.

Bus

Bus numbers: 150/155/157 from North Terrace leaving the city every 15 minutes to **STOP 7** on Port Road.

Train

Grange or Outer Harbour train to Bowden Station.

Tram

Alight at the Entertainment Centre heading west for 543m walk to the Education Development Centre.

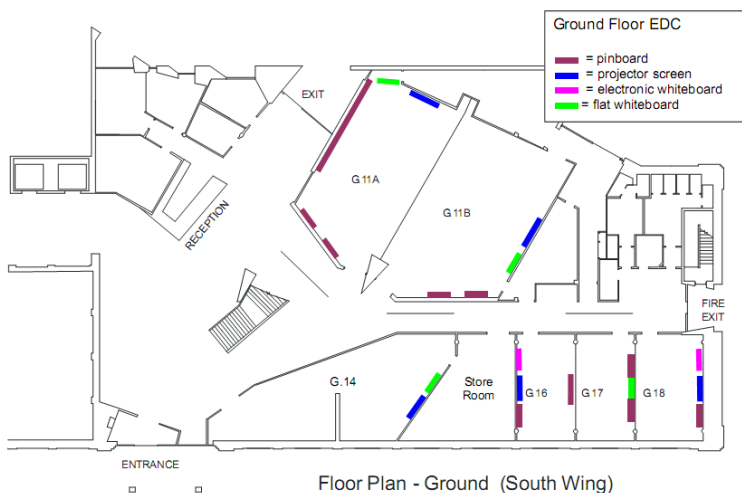
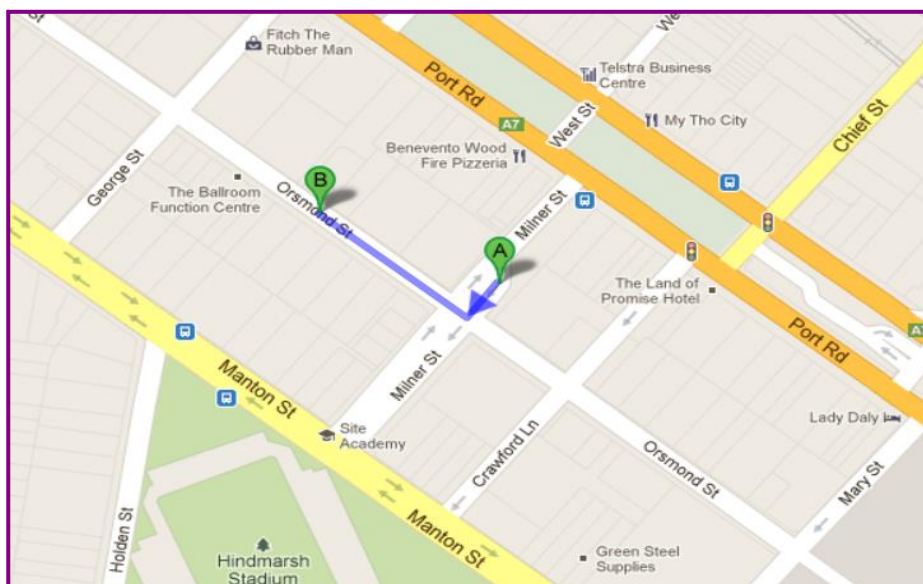

Milner Street